

DATE STAMPS

MICRODATERS®

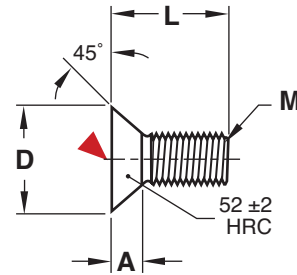
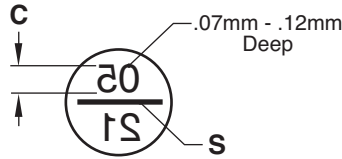
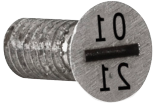

M 420 Stainless (1.4034) **H** 50-54 HRC

CAD insertion point

CATALOG NUMBER	D	L	A	M	C	F	T	S Width x Depth	BLANK CAT. NO.
MD02	2	5	.45	M1.4x0.3	.50	1.14	1.4	.38 x .25	MD02-B
MD03	3	5	.76	M1.8x0.35	.75	1.52	1.8	.38 x .38	MD03-B
MD04	4	6	.89	M2.5x0.45	1.0	1.65	2.7	.38 x .38	MD04-B

Blank (-B) MicroDaters do not have numbers or the removal slot, ready for custom engraving by the mold maker.

Design Options:

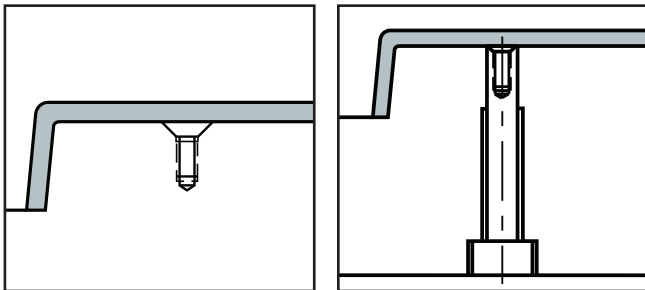

Installation Guidelines:

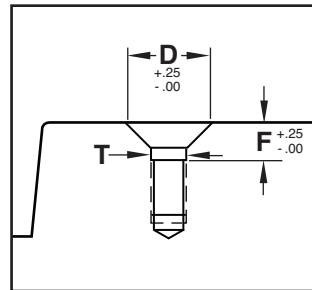

Microdaters can be installed directly into the plates or inserts or into a core pin or ejector pin with the material hardness around 35-40 HRC to utilize conventional machining methods.

Drill, tap and counterbore the dater as shown at left and to the dimensions in the chart above.

To Order:

- MicroDaters can be ordered individually or in 12-month sets.
- For individual month daters, specify the 2-digit month and year at the end of the catalog number:
Ex. MD04-03-21 for a 4mm screw for March 2021.
- To order a 12-month set, specify a "Y" at the end of the catalog number, followed by the 2-digit month and year that begins the series:
Ex. MD03-Y-03-21 would yield (12) 3mm screws starting with March 2021, ending with February 2022. Shown below at 2:1 scale.

